

Redmayne Arnold & Harris  
estate agents, letting agents & surveyors

[rah.co.uk](http://rah.co.uk)



TO LET



12 Garden Court, Adam and Eve Street, Cambridge, CB1 1DW

£1,150 PCM



THE PROPERTY

A part-furnished second floor studio apartment, located within close proximity to the city centre and The Grafton. The property comprises entrance hall, open-plan living space with built-in bed and kitchen and shower room. Please note that there is no parking available with the apartment. There is a lift in the development. The property is managed by RAH. Council Tax Band - A. EPC Rating - C.  
12 month tenancy  
Deposit £1320

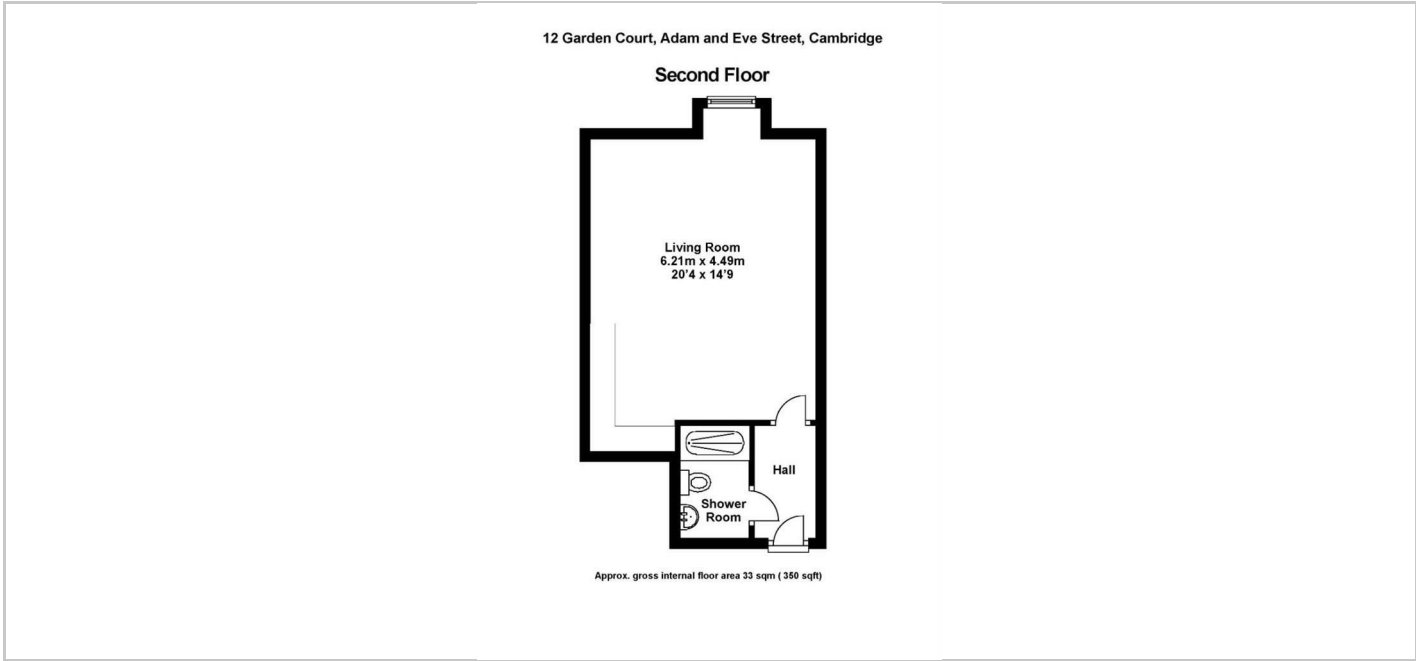

Directions

SITUATION

